



The VICTORIAN II



Features Included:

- Wrap Around Porch
- Spacious Kit w/Island
- 2.5-Car Garage
- Walk-in Pantry
- Tray Ceiling in Master Bedrm
- Brick Accent on Front Elev

2,213 Sq. Ft.

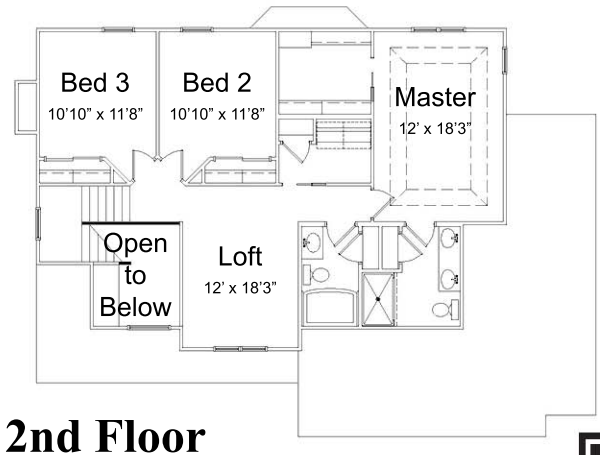

www.mchomebuildersllc.com

Plans, Room Sizes, Exteriors as shown,
Subject to change.

