

# BRUNSWICK CAPE

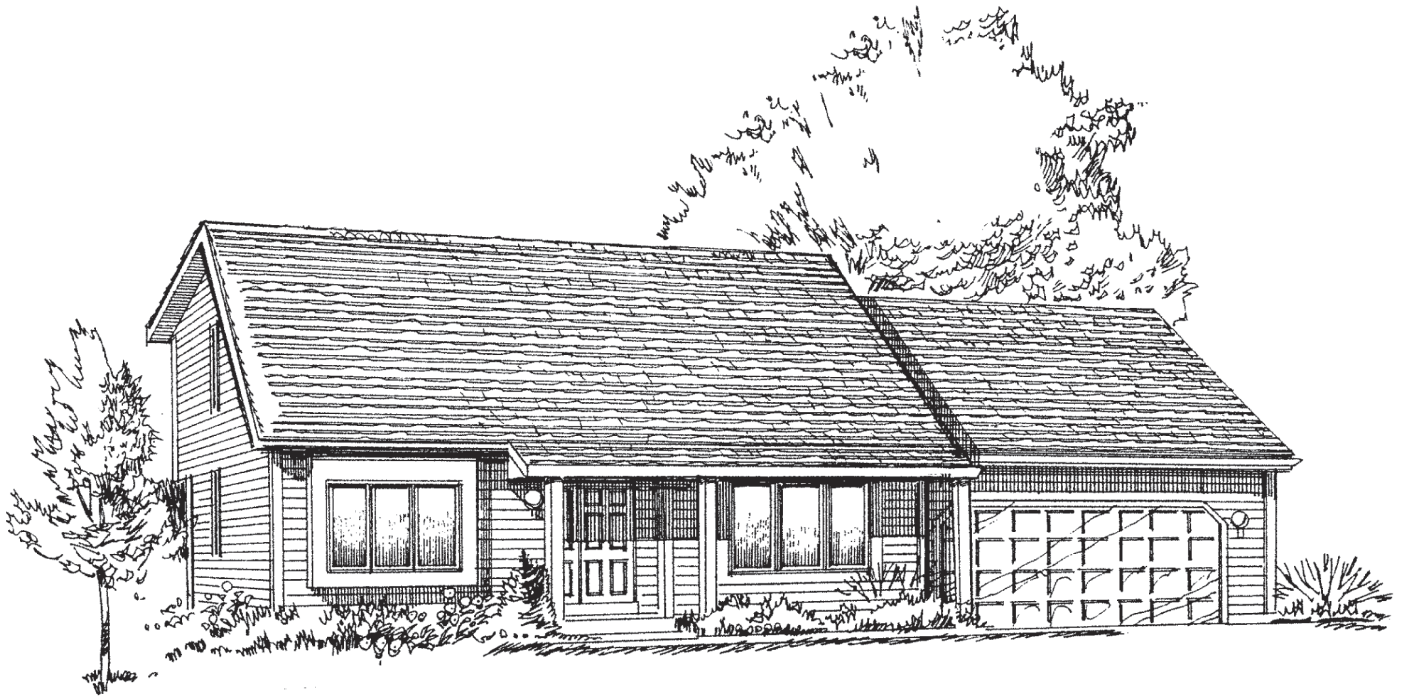

34-0

56-0

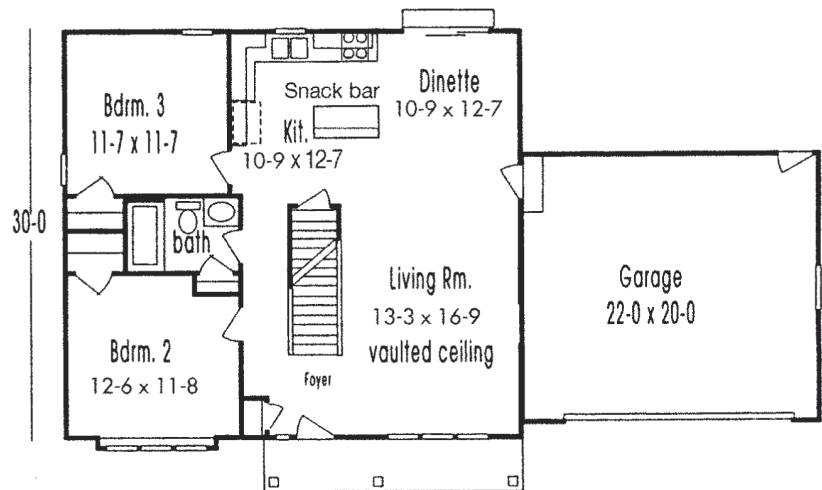
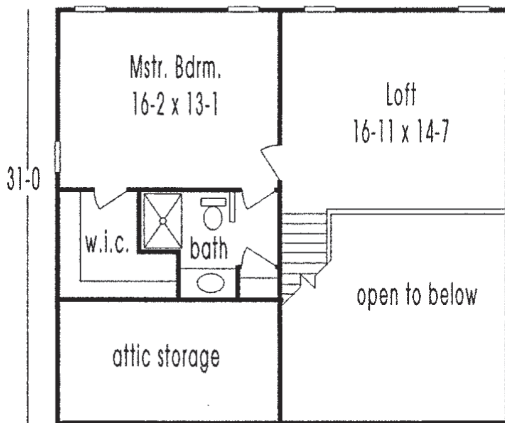

4 Bedroom Option Available

1st Floor - 1020 sq. ft.  
2nd Floor - 626 sq. ft.

## Brunswick Cape

1646 Sq. Ft.

### Features Included

- Vaulted Living Room
- Loft w/oak spindle work
- 3 Bedroom Plan

Plans, Room sizes,  
Exteriors as shown  
subject to change.

